

Date: \_\_\_\_\_ For:  File  Resubmit  
 PO No.: \_\_\_\_\_  Approval  Other \_\_\_\_\_  
 Architect: \_\_\_\_\_ GC: \_\_\_\_\_  
 Engr: \_\_\_\_\_ Mech: \_\_\_\_\_  
 Rep: \_\_\_\_\_  
 (Company) (Project Manager)



**ARNH963K2A2**  
 Hydro Kit Medium Temperature  
 96 MBh Indoor Unit



**Performance:**

**Cooling Mode:**

Rated Capacity (Btu/h)	95,900
Entering Water Temperature Range (°F)	50-86
Leaving Water Temperature Range (°F)	42-77

**Heating Mode:**

Rated Capacity (Btu/h)	107,500
Entering Water Temperature Range (°F)	59-113
Leaving Water Temperature Range (°F)	68-122

**Air Source Outdoor Unit**

Cooling Rated Test Conditions: Heating Rated Test Conditions:  
 Bldg Water: 95°F DB/75°F WB Bldg Water: 47°F DB/43°F WB  
 Water Temp. Inlet/Outlet: 73.4°F/65.5°F Water Inlet/Outlet: 86°F/94.8°F  
 Interconnected refrigerant pipe length is 25 ft at 0 elevation change.

**Water Source Unit:**

Cooling Rated Test Conditions: Heating Rated Test Conditions:  
 Bldg Water: 95°F Bldg Water: 47°F  
 Water Temp. Inlet/Outlet: 73.4°F/65.5°F Water Temp. Inlet/Outlet: 86°F/94.8°F  
 Interconnected refrigerant pipe length is 25 ft at 0 elevation change.

**Electrical:**

Power Supply <sup>1</sup> (V/Hz/Ø)	208-230/60/1
Power Input (kW) Cooling/Heating	0.01
Rated Amps (A)	0.05
MCA (A)	0.06
MOP (A)	15

MCA - Minimum Circuit Ampacity MOP - Maximum Overcurrent Protection

**Piping:**

Liquid Line (in, OD)	3/8 Braze
Vapor Line (in, OD)	7/8 Braze
Water Inlet/Outlet (in, OD)	1-MPT
Condensate Outlet (in, OD)	1-MPT

MPT - Male Pipe Thread

**Included Accessories**

- Hot Water Tank Temp Sensor with 32 ft communication cable <sup>2,3</sup>
- 1/2" MPT Hot Water Tank Sensor Well<sup>2</sup>
- Remote Wall Mounted Hydro Kit Controller with 32 ft communication cable <sup>2, 3A</sup>
- Standby Power Module <sup>2,4</sup>
- 1" Female Pipe Thread (FPT) #50 mesh inlet strainer<sup>2</sup>

**Optional Accessories (sold separately)**

- Dry Contact – PQDSB1
- Remote Temperature Sensor – PQRSTAO
- Wired Remote Group Control Cable Assembly – PZWRCG3 <sup>2,5</sup>
- Solar Heating System Interface Kit - PHLLA

**Unit Data:**

Refrigerant Type	R410A
Refrigerant Control	EEV
Sound Pressure <sup>6</sup> dB(A) Heating/Cooling	26/26
Net Weight (lbs)	77
Shipping Weight (lbs)	89
Heat Rejected to Equipment Room (Btu/h)	Negligible
Factory Charge	Dry Nitrogen

**Heat Exchanger:**

Heat Exchanger	Refrigerant to Water
Heat Exchanger Type	316 Stainless Brazed Plate
Rated Water Flow (GPM)	24.3
Nominal Pressure Drop <sup>7</sup> (ft-wg)	23.1
Range of Flow (GPM)	8-24.3
Water Side Volume (US Gallons)	0.58
Water Side Design Pressure (psig)	464

**Water Flow Control Options:**

- Water Pump On/Off Interlock
- 208V 3-Way Diverting Valve <sup>8,9,10</sup>
- 208V 2-Way Heating Circuit Isolation Valve <sup>8,10,11</sup>

**Standard Features:**

- Water cooling and medium temperature heating
- Domestic water heating<sup>12</sup>
- Cold surface insulation
- Factory mounted inlet/outlet water temperature sensors
- Factory mounted internal flow switch
- Third party thermostat interface <sup>10,13</sup>
- Group control<sup>14</sup>
- Remote on/off site monitoring capability via the internet<sup>15</sup>

**Notes:**

1. Voltage fluctuation tolerance is ±10%.
2. Field mounted.
3. Cannot field splice.
- 3A. To extend cable length, use Group Control Extension Cable (PZCWR1), sold separately.
4. On power outage, closes EEV valve(s) to prevent heat exchanger freezing.
5. Requires the installation of the Hydro Kit controller. Does not apply when used in conjunction with 3rd party thermostat.
6. Sound pressure levels tested in an anechoic chamber in accordance with ISO Standard 3475.
7. Water only (no antifreeze).
8. Not required on dedicated domestic water heating applications.
9. Alternates flow between comfort cooling/heating equipment and water heating tank.
10. Field provided and mounted.
11. Shut-off flow to in-floor heating circuit while operating in cooling mode.
12. Requires the use of an indirect water storage tank.
13. Field provided thermostat must be a 208V, 24V or mechanical type. Must be field adjustable heating only or cooling/heating with a manual changeover. Cooling and heating setpoint, deadband, and manual restart functions provided by Hydro Kit Controller are not available with use of a 3rd party thermostat. Cannot be used in conjunction with remote temperature sensor.
14. Wired Remote Group Control Cable Assembly (PZWRCG3) required and sold separately.
15. Monitoring capability available using LG's AC Smart Premium or a BMS system integration gateway (sold separately). Requires a field provided LAN/internet connection or BMS system provided by others.



**ARNH963K2A2**  
 Hydro Kit Medium Temperature  
 96 MBh Combination Water Heater and Cooler



Tag #: \_\_\_\_\_  
 Date: \_\_\_\_\_  
 PO No.: \_\_\_\_\_

Front View

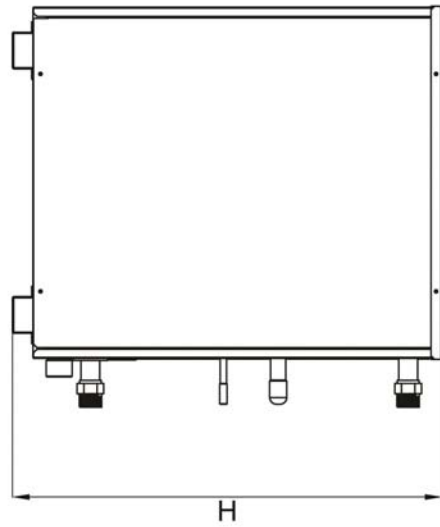

Top View

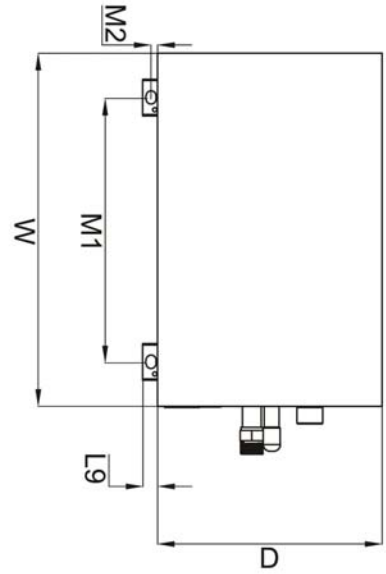

Side View

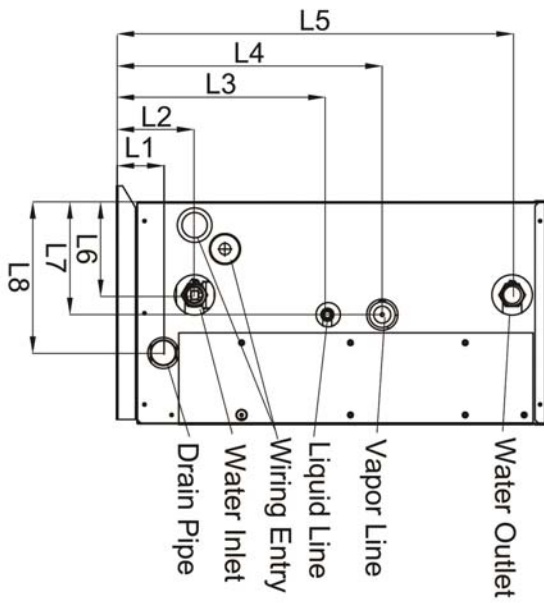

W	20-5/8"
D	13-1/8"
H	24-3/4"
L1	2-3/4"
L2	4-9/16"
L3	12-7/16"
L4	15-9/16"
L5	22-7/8"
L6	5-7/16"
L7	6-9/16"
L8	8-3/4"
L9	7/8"
M1	15-7/16"
M2	7/16"